

NOTES:

1. 6" MIN. CONCRETE SLAB TO BE POURED TO GROUND CUT.
2. INVERTS TO IN & OUT PIPES TO BE BUILT AFTER MANHOLE HAS BEEN SET.
3. MANHOLE TO BE LEVELED & ASSEMBLED SO AS TO EVENLY DISTRIBUTE WALL BEARING LOAD.
4. SEE DETAIL 71B-2 FOR REINFORCING DETAILS AND STEP DETAILS.
5. 6" MIN. EXTENSION BEYOND EXTERIOR WALL OF MANHOLE.
6. PRECAST MANHOLE JOINTS TO BE SEALED WITH "O" RING JOINT-ASTM C-443 OR WITH APPROVED BUTYL RUBBER SEALANT.
7. CONCRETE SLAB SHALL EXTEND A MIN. OF 3" ABOVE BOTTOM OF FIRST MANHOLE SECTION.
8. ALL LIFT HOLES TO BE SEALED WITH TAPERED NEOPRENE PLUGS OR OTHER APPROVED EQUAL. LIFT HOLES TO BE SEALED FROM OUTSIDE.
9. PROVIDE REINFORCED CONCRETE FOOTING WHEN MANHOLE IS GREATER THEN 12' OR ON POOR SOIL BASE.
10. MANHOLE MUST MEET ASSHTO M199
11. PROVIDE NEOPRENE BOOT KOR-N-SEAL ON ALL PRECAST MANHOLES (OR EQUAL)
11. PROVIDE NON-MAGNETIC, CORROSION-RESISTANT PIPE CLAMP (300 SERIES)
13. PROVIDE KORBAND 6061-T6 ALUMINUM ALLOY EXPANSION BAND (OE EQUAL)

4" THICK 95% PROCTOR COMPACTED #57 WASHED STONE TO BE 6" CONCRETE W/OUTSIDE DROP.

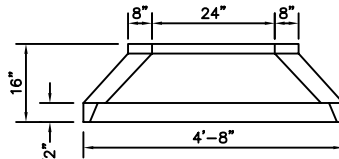

OPTIONAL CONE FOR SHALLOW MANHOLE

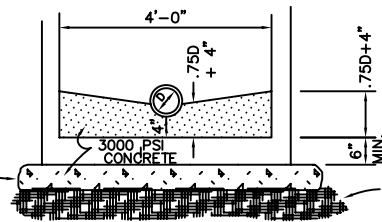

OPTIONAL MONOLITHIC BASE

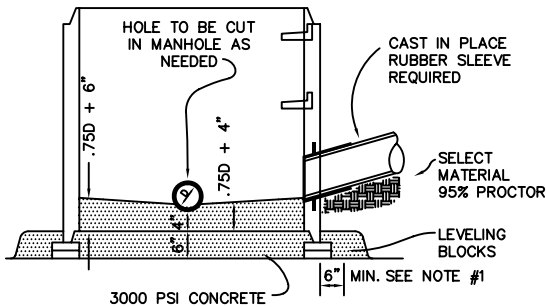
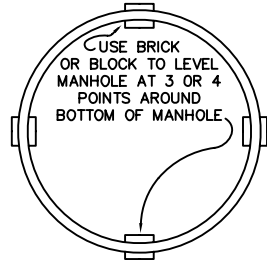

FOR STANDARD DETAIL OF FRAME & COVER SEE SHEET

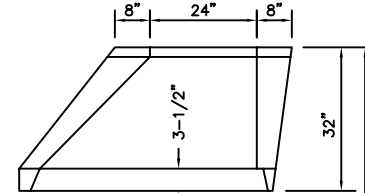

NOTE: PRECAST MANHOLE MAY BE CONSTRUCTED TO A MAXIMUM DEPTH OF 14' USING 4' PRECAST MANHOLE SECTIONS. IF MANHOLE DEPTH EXCEEDS 14', USE 5' MANHOLE SECTIONS AS SHOWN.

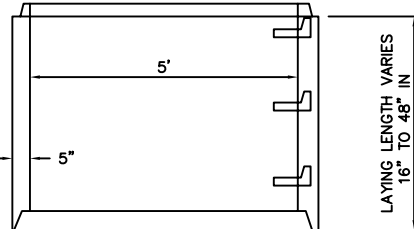
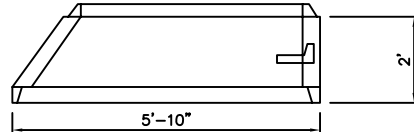
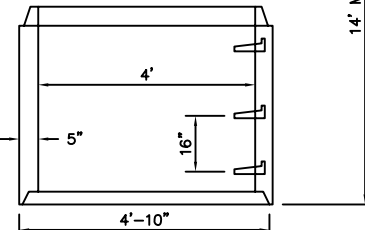

STANDARD FOOTING AS SHOWN AT LEFT TO BE USED.

DATE: 7/1/93	REVISIONS	STANDARD DETAIL	LEXINGTON COUNTY JOINT MUNICIPAL WATER AND SEWER COMMISSION
SCALE: NTS			PRECAST CONCRETE MANHOLE